

# CITY OF TUSCALOOSA

## 31ST AVENUE EAST CROSS DRAIN REPAIR OCE PROJECT: 2020.038

  
**OFFICE OF THE CITY ENGINEER**  
 2201 UNIVERSITY BLVD  
 TUSCALOOSA, AL 35401  
 PHONE: (205) 248-5380  
**CITY OF TUSCALOOSA ENGINEERING**

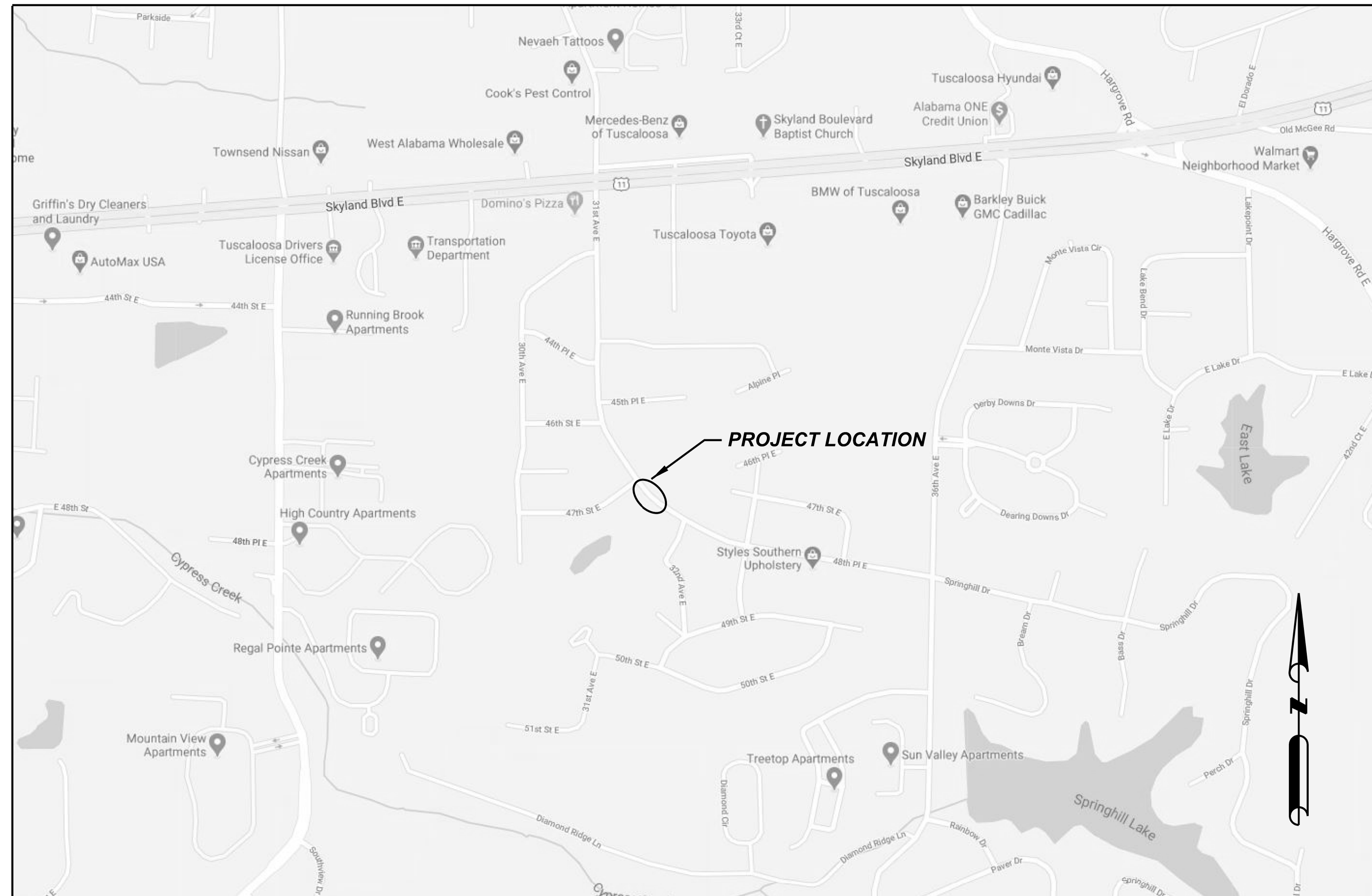

VICINITY MAP  
N.T.S.

### INDEX TO SHEETS

TITLE SHEET	C0.1
PROJECT NOTES	C0.2
PLAN & PROFILE	C2.0
TEMPORARY TRAFFIC CONTROL PLAN	C3.0
STANDARD DETAILS	C4.0
STANDARD DETAILS	C4.1

**31ST AVENUE EAST  
CROSS DRAIN REPAIR  
TITLE SHEET**



NO.	DATE	DESCRIPTION

DRAWN BY: CRC	CHECKED BY: MWG
DATE: 7/17/2020	PROJECT NO.: 2020.038

SHEET NUMBER  
**C0.1**

**GENERAL PROJECT NOTES:**

- WHEN TEMPORARY ASPHALT PATCHING OCCURS, THE MIX SHALL BE HOT MIXED. ASPHALT COLD MIXES SHALL NOT BE ACCEPTED. POORLY PATCHED CROSSINGS DISPLAYING NONUNIFORM, UNSMOOTH FINISHES SHALL NOT BE ACCEPTED AND SHALL BE REMOVED AT ONCE. THE REPATCH OF THE AREA SHALL BE PAID FOR AT THE CONTRACTORS EXPENSE.
- THE CONTRACTOR SHALL KEEP THE PROJECT CLEAN FROM TRASH AND DEBRIS. PLACEMENT/DISCARDING OF TRASH AND REFUSE IN UTILITY TRENCHES AND OR THE EXCAVATIONS ASSOCIATED WITH THE PROJECT SHALL BE PROHIBITED. THE CONTRACTOR SHALL PROVIDE TRASH CONTAINERS FOR WORKER USE. THE ROADWAYS AND SIDEWALKS SHALL BE SWEEPED AND WASHED DOWN EACH DAY IF NECESSARY TO LIMIT THE TRACKING OF DIRT THROUGH THE PROJECT.
- EXISTING SANITARY SEWER, STORM DRAIN, WATER DISTRIBUTION/FIRE PROTECTION, ETC. INFRASTRUCTURE TO BE RETAINED AS PART OF THIS PROJECT SHALL BE PROTECTED AT ALL TIMES. ANY DAMAGE TO THESE STRUCTURES SHALL BE REPAIRED TO THE OWNERS SATISFACTION AT THE CONTRACTOR'S EXPENSE.
- IT SHALL BE THE CONTRACTOR'S RESPONSIBILITY TO DETERMINE THE SPECIFIC DEMOLITION ELEMENTS WITHIN THE CONSTRUCTION LIMITS. ALL REQUIRED DEMOLITION DETAILS MAY NOT BE SPECIFIC WITHIN THE CONSTRUCTION DOCUMENTS. THE CONTRACTOR SHALL BE RESPONSIBLE FOR DEMOLITION AND/OR REMOVAL OF ANY ITEMS WITHIN THE CONSTRUCTION LIMITS.
- ALL MATERIAL AND CONSTRUCTION SHALL COMPLY WITH CURRENT CITY OF TUSCALOOSA (OFFICE OF THE CITY ENGINEER) AND ALABAMA DEPARTMENT OF TRANSPORTATION STANDARDS AND POLICIES.
- TOPOGRAPHIC INFORMATION SHOWN AS SCREENED ARE EXISTING CONDITIONS BASED ON FIELD SURVEY PERFORMED BY CITY OF TUSCALOOSA IN JUNE 2020.

**PAVING, SIGNING AND STRIPING NOTES:**

- THE CONTRACTOR SHALL SAW CUT ALL EXISTING PAVEMENTS TO BE REMOVED WITH A STRAIGHT, CLEAN REMOVAL JOINT TO INSURE PROPOSED PAVEMENTS JOIN TO EXISTING PAVEMENTS CLEANLY.
- ALL COMBINATION CURB AND GUTTER SHALL BE TWO (2) FEET IN WIDTH UNLESS OTHERWISE SHOWN ON THE CONSTRUCTION PLANS. IF EXISTING CURB AND GUTTER VARIES IN WIDTH THE PROPOSED CURB AND GUTTER SHALL BE TAPERED TO JOIN TO IT OVER A MINIMUM DISTANCE OF FIVE (5) FEET TO INSURE A SMOOTH TRANSITION.
- ALL SIGNS, STRIPING, MARKINGS, ETC. SHALL BE OF COLOR AND TYPE SHOWN AND SHALL CONFORM TO THE LATEST EDITION OF THE MANUAL OF UNIFORM TRAFFIC CONTROL DEVICES AND ALABAMA DEPARTMENT OF TRANSPORTATION SPECIFICATIONS, UNLESS OTHERWISE NOTED.

**EROSION CONTROL NOTES:**

- THE AREA OF LAND DISTURBANCE DOES NOT EXCEED 1 ACRE FOR THIS PROJECT, THEREFORE AN ADEM NPDES CONSTRUCTION STORMWATER DISCHARGE PERMIT IS NOT REQUIRED. THE ESTIMATED LAND DISTURBANCE FOR THIS PROJECT IS 0.11 ACRES.
- THE PROJECT AREA SHALL REMAIN CLEAN AT ALL TIMES. THE CONTRACTOR SHALL USE WHATEVER MEANS NECESSARY TO KEEP THE PROJECT AREA CLEAN INCLUDING MOTORIZED STREET SWEEPERS, WATER AND VACUUM TRUCKS, HAND SWEEPING, AND SHOVELING, ETC. IT IS THE CONTRACTOR'S RESPONSIBILITY TO ADDRESS THIS ISSUE EACH DAY INCLUDING WEEKENDS AND SPECIFICALLY BEFORE AND AFTER ANY RAIN EVENTS.
- THE CONTRACTOR SHALL IDENTIFY ENTRANCE/EXIT LOCATIONS FOR EQUIPMENT AND INSTALL TEMPORARY GRAVEL DRIVES TO REDUCE TRACKING ONTO PUBLIC RIGHT OF WAY. THE CONTRACTOR SHALL BE RESPONSIBLE FOR KEEPING ALL STREETS CLEAN OF ANY SEDIMENT FROM THE CONSTRUCTION SITE.
- THE CONTRACTOR SHALL INSTALL STONE AND/OR STABILIZE EXISTING ENTRANCE/EXIT AS NECESSARY. ALL STONE FOR CONSTRUCTION ENTRANCE/EXIT IS CONSIDERED INCIDENTAL REGARDLESS THE NUMBER OF TIMES FRESH STONE IS REQUIRED FOR EROSION CONTROL MEASURES.
- THE CONTRACTOR SHALL BE RESPONSIBLE FOR USING BEST MANAGEMENT PRACTICES (BMP'S) FOR EROSION AND SEDIMENT CONTROL THROUGHOUT CONSTRUCTION. NO EXTRA COMPENSATION SHALL BE GIVEN TO THE CONTRACTOR FOR MAINTAINING EROSION CONTROL ITEMS OR ADDITIONAL EROSION ITEMS REQUIRED TO PROVIDE EROSION AND SEDIMENT CONTROL TO THE SATISFACTION OF THE ENGINEER.
- IT IS THE RESPONSIBILITY OF THE CONTRACTOR TO MAINTAIN AND KEEP CLEAN ALL EROSION CONTROL STRUCTURES UNTIL AS DEEMED NO LONGER NECESSARY BY THE ENGINEER.
- SILT FENCES SHALL HAVE SEDIMENT DEPOSITS REMOVED IF THEY REACH A DEPTH OF FIFTEEN INCHES (15") OR 1/2 THE HEIGHT OF THE FENCE. SEDIMENT REMOVED FROM THE SILT FENCE SHALL BE REMOVED FROM THE SITE.
- ALL DISTURBED AREAS SHALL BE STABILIZED UPON COMPLETION OF GRADING OPERATIONS. ADEM REGULATIONS REQUIRE ALL DISTURBED AREAS NOT UNDERGOING ACTIVE DISTURBANCE OR ACTIVE CONSTRUCTION FOR LONGER THAN THIRTEEN (13) DAYS TO BE STABILIZED TO ESTABLISH TEMPORARY VEGETATIVE COVER.

**TRAFFIC CONTROL NOTES:**

- ALL MATERIAL USED FOR TEMPORARY TRAFFIC STRIPING SHALL COMPLY WITH SECTION 857 OF THE ALABAMA DEPARTMENT OF TRANSPORTATION STANDARD SPECIFICATIONS FOR HIGHWAY CONSTRUCTION, LATEST EDITION.
- INSTALLATION OF ALL TEMPORARY TRAFFIC STRIPE SHALL COMPLY WITH SECTION 701 OF THE ALABAMA DEPARTMENT OF TRANSPORTATION STANDARD SPECIFICATIONS FOR HIGHWAY CONSTRUCTION, LATEST EDITION.
- TEMPORARY TRAFFIC STRIPES SHALL BE REFLECTORIZED PAINT.
- ROAD WORK AHEAD SIGNS SHALL BE POST MOUNTED ON ALL SIDE STREETS THAT FALL WITHIN THE PROJECT LIMITS FOR THE DURATION OF THE PROJECT.
- LENGTH BETWEEN SIGNS SHALL VARY BASED ON MUTCD AND DESIGN SPEED. THE CONTRACTOR SHALL MODIFY AS PER MUTCD WHEN NECESSARY BASED ON LOCATION OF ROAD WORK.
- ALL TRAFFIC CONTROL DEVICES THAT ARE NOT APPLICABLE AT ANY SPECIFIC TIME SHALL BE COVERED OR REMOVED AS DIRECTED BY THE ENGINEER. COST SHALL BE INCIDENTAL TO THE PROJECT.
- THE CONTRACTOR SHALL MAKE PROVISIONS FOR THE SAFETY OF PEDESTRIAN TRAFFIC CROSSING THE WORK ZONES DURING CONSTRUCTION.
- THE TRAFFIC CONTROL PLAN (TCP) IS NOT ALL INCLUSIVE. THE TCP PROVIDES SEVERAL DETAILED DRAWINGS INDICATING THE MINIMUM TRAFFIC CONTROL NECESSARY FOR THE DIFFERENT CONSTRUCTION ACTIVITIES ANTICIPATED FOR THIS PROJECT. THE CONTRACTOR SHALL SELECT THE DETAILED DRAWING THAT BEST FITS THE ACTIVITY TO BE PERFORMED.
- FLAGGERS ARE TO BE USED WHEN DIRECTED BY THE ENGINEER. SIGNS SHALL BE PLACED AT THE APPROPRIATE TIME, AND SHALL BE COVERED OR REMOVED WHEN FLAGGERS ARE NOT ON DUTY AND DURING NON-WORKING HOURS.
- FLAGGERS SHALL BE PROPERLY ATTIRED. EQUIPPED WITH STAFF MOUNTED STOP/SLOW PADDLES IN SIGHT OF EACH OTHER OR HAVE DIRECT COMMUNICATION AT ALL TIMES. FLAGGER STATION LOCATION MAY BE VARIED FROM THOSE SHOWN BASED ON ROADWAY ALIGNMENT AND CONDITIONS AT THE TIME OF THE LANE CLOSURE.
- THE CONTRACTOR SHALL PLACE ALL ADVANCE WARNING SIGNS BEFORE PROCEEDING WITH HIS WORK. SIGNS SHALL BE PLACED IN ORDER, IN THE DIRECTION OF TRAFFIC AND REMOVED IN REVERSE ORDER.
- DURING NON-WORKING HOURS NO EQUIPMENT OR MATERIAL SHALL BE PARKED OR STORED CLOSER THAN 30 FEET TO THE EDGE OF ANY ROADWAY CARRYING TRAFFIC. WHEN THIS IS NOT PRACTICAL, IT SHALL BE PLACED IN AN AREA DESIGNATED BY THE ENGINEER AND DELINEATED BY REFLECTORIZED DRUMS AND WARNING LIGHTS. THIS INCLUDES STORAGE OF TRAFFIC CONTROL DEVICES SUCH AS TRAILER MOUNTED OR OTHER TEMPORARY SIGNS, BARRICADES, DRUMS, ETC., WHICH ARE NOT IN USE DURING NON-WORKING HOURS.
- ALL BLACK OR ORANGE CONSTRUCTION SIGNS SHALL BE FABRICATED USING TYPES IV, VII, OR VIII FLUORESCENT ORANGE REFLECTIVE SHEETING MATERIAL FOR THE SIGN BACKGROUND.
- THE TRAFFIC CONTROL PLAN IS DEVELOPED IN CONFORMANCE WITH THE MANUAL ON UNIFORM TRAFFIC CONTROL DEVICES LATEST EDITION. THE TRAFFIC CONTROL DEVICES INDICATED REPRESENT CONDITIONS KNOWN DURING PLAN DEVELOPMENT. IN THE EVENT ACTUAL PHYSICAL CONDITIONS WARRANT ADDITIONAL TRAFFIC CONTROL DEVICES, THEY SHALL BE INSTALLED IN CONFORMANCE WITH THE M. U. T. C. D. PART VI.
- THE CONTRACTOR SHALL COORDINATE ALL TRAFFIC/PARKING DISRUPTIONS WITH THE CITY OF TUSCALOOSA. A MINIMUM OF 72 HOURS NOTICE SHALL BE REQUIRED. CONTRACTOR SHALL BE RESPONSIBLE FOR ANY AND ALL COST ASSOCIATED WITH TRAFFIC CONTROL.

**GRADING NOTES:**

- ALL DISTURBED AREA SHALL HAVE A MINIMUM OF 4" TOPSOIL APPLIED, BE GRASSED AND MULCHED, AND/OR SODDED AS SOON AS FINAL GRADING IS COMPLETE. REFER TO EROSION CONTROL NOTES FOR TEMPORARY GRASSING AND MULCHING DURING GRADING OPERATIONS.
- ALL EXISTING WATER VALVES, UTILITY VAULT TOPS, METER BOXES, ROADWAY SIGNS, INFORMATIONAL SIGNS, ETC. SHALL BE REMOVED, STOCKPILED IN A SECURE LOCATION, AND/OR RESET FOR THE OWNER AS PER THE CONTRACT DOCUMENTS.

**UTILITY NOTES:**

- THE LOCATIONS OF EXISTING UTILITIES ARE SHOWN IN AN APPROXIMATE WAY ONLY. THE CONTRACTOR SHALL DETERMINE THE EXACT LOCATION OF ALL EXISTING UTILITIES WHETHER SHOWN ON THE PLANS OR NOT BEFORE COMMENCING WORK. THE CONTRACTOR SHALL BE RESPONSIBLE FOR ANY AND ALL DAMAGE TO EXISTING UTILITIES.
- THE CONTRACTOR SHALL BE PREPARED TO CAMERA ANY UTILITIES DISCOVERED DURING CONSTRUCTION NOT SHOWN ON THE PLANS TO VERIFY IF THE UTILITY SHOULD BE TIED TO THE PROPOSED SYSTEM, ABANDONED, REMOVED, ETC. THIS WORK SHALL BE CONSIDERED INCIDENTAL AND NO ADDITIONAL COMPENSATION SHALL BE GIVEN.
- ALL STORM DRAIN, SANITARY SEWER, AND WATER DISTRIBUTION SYSTEMS SHALL REMAIN ACTIVE UNTIL PROPOSED PROJECT UTILITIES ARE INSTALLED AND CAN COME INTO SERVICE.



Know what's below.  
Call before you dig.

**UTILITY CONTACTS**

**POWER**  
ALABAMA POWER COMPANY  
CONTACT: MR. JAMES RAYMOND  
915 QUEEN CITY AVENUE  
TUSCALOOSA, AL 35401  
(205) 349-6744  
(800) 888-2726 (POWER OUTAGE)

**CABLE**  
COMCAST CABLE  
CONTACT: MR. DANIEL HOLT  
CONSTRUCTION COORDINATOR  
1131 WHIGHAM PLACE  
TUSCALOOSA, AL 35405  
OFFICE: (205) 391-3687  
MOBILE: (205) 233-4181

**PHONE**  
AT&T  
CONTACT: MR. TYLER MCDONALD  
3121 BUTTERMILK ROAD  
COTTONDALE, AL 35403  
(205) 562-3096

**GAS**  
SPIRE  
CONTACT: MR. JOHN PRICE  
5520 METRO PARK DRIVE  
TUSCALOOSA, AL 35405  
(205) 233-2141

**CITY OF TUSCALOOSA**  
OFFICE OF THE CITY ENGINEER (OCE)  
CONTACT: CALVIN CULLIVER  
2201 UNIVERSITY BOULEVARD  
TUSCALOOSA, AL 35401  
(205) 248-5382

**SURVEY LEGEND**

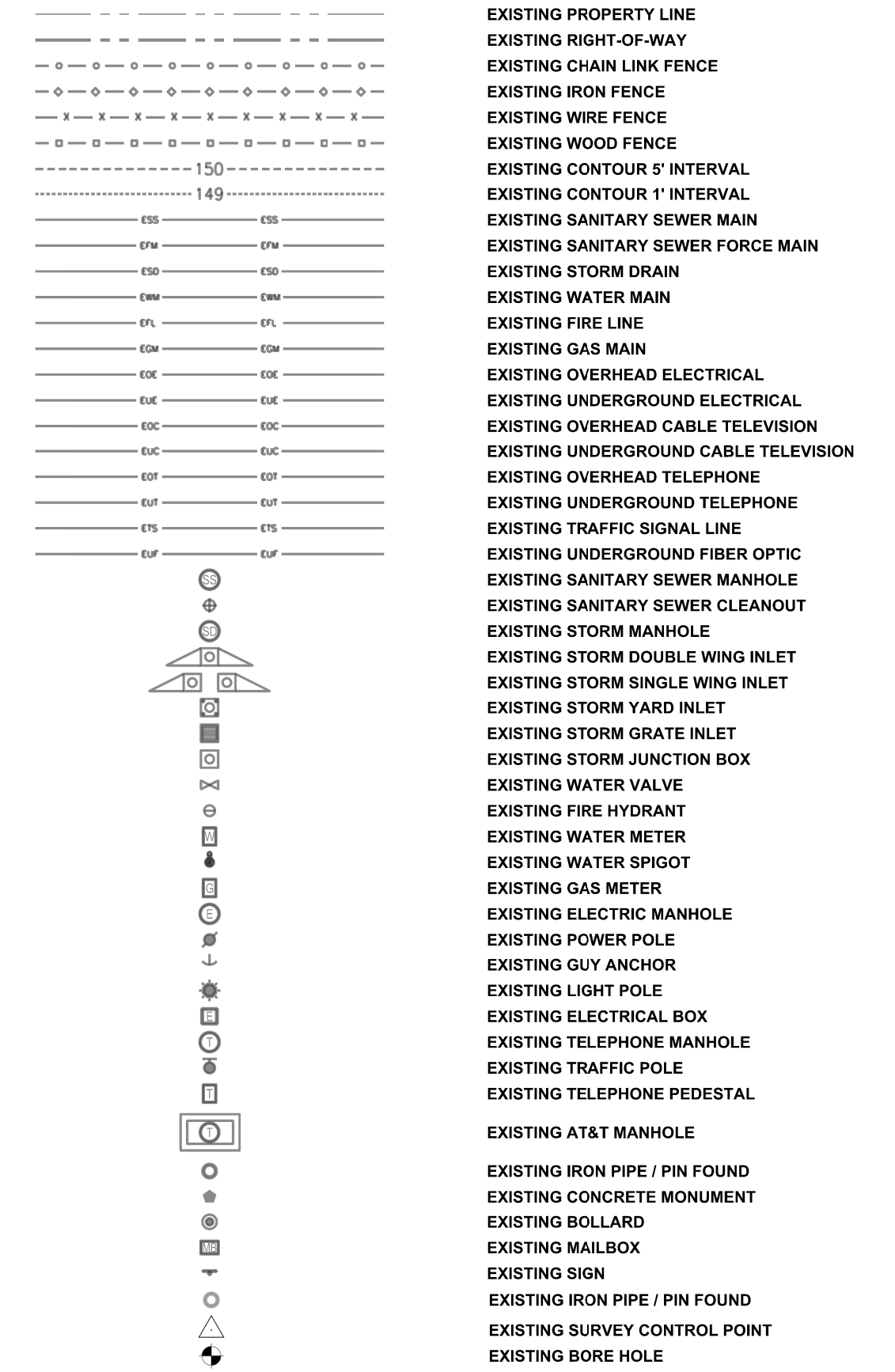

**DESIGN LEGEND**

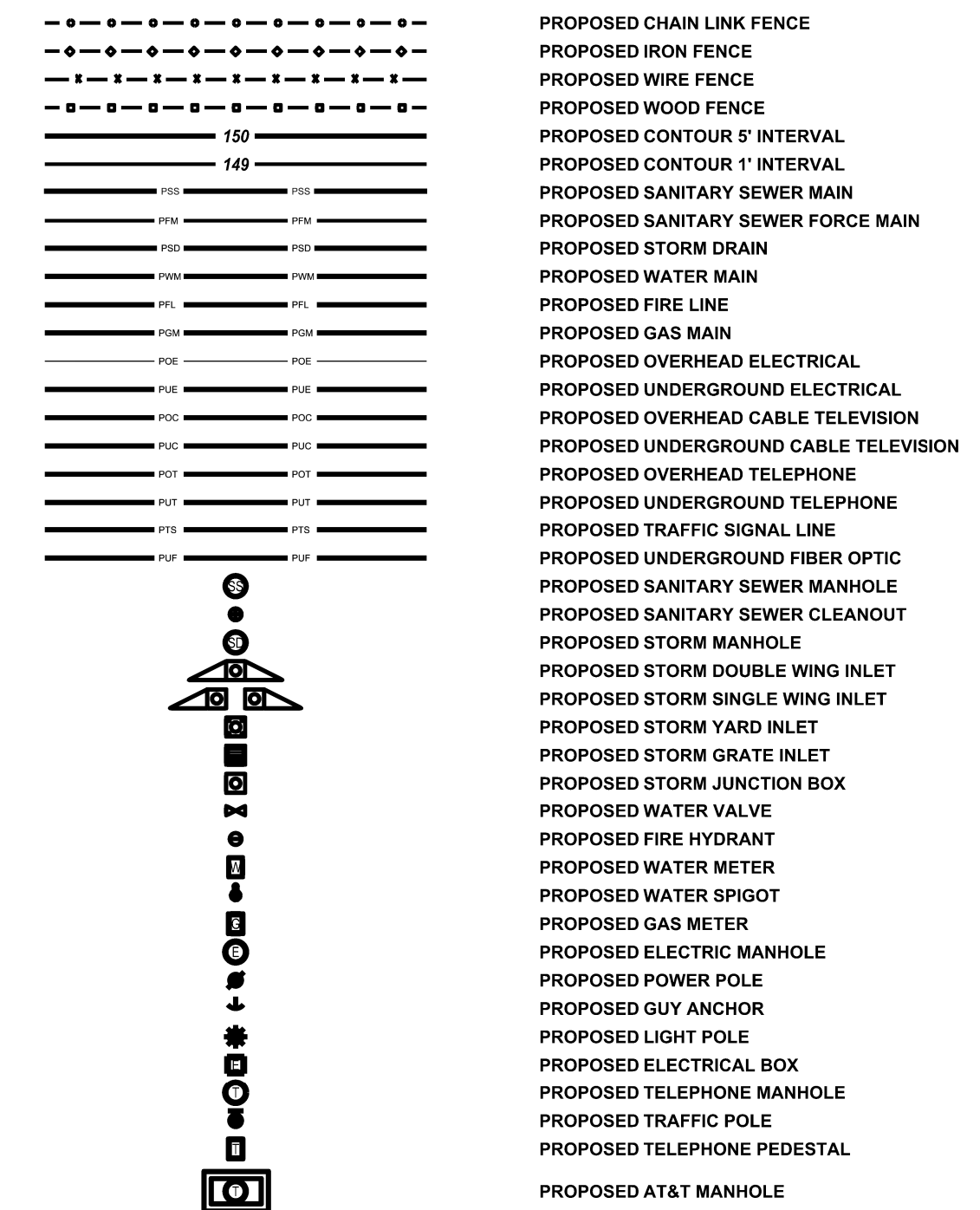

**OFFICE OF THE CITY ENGINEER**  
2201 UNIVERSITY BLVD  
TUSCALOOSA, AL 35401  
PHONE: (205) 248-5380

City of  
**TUSCALOOSA**  
ENGINEERING

**31ST AVENUE EAST  
CROSS DRAIN REPAIR**

**PROJECT NOTES**

NO.	DATE	DESCRIPTION

DRAWN BY: CRC  
DATE: 7/17/2020

CHECKED BY: MWG  
PROJECT NO.: 2020.038



SHEET NUMBER  
**C0.2**

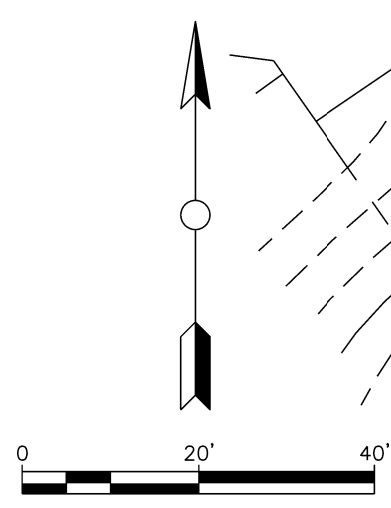

**SURVEY LEGEND**

- 320 --- EXISTING PROPERTY LINE
- 320 --- EXISTING CONTOUR 10' INTERVAL
- 320 --- EXISTING CONTOUR 2' INTERVAL
- ESS --- EXISTING SANITARY SEWER MAIN
- ESD --- EXISTING STORM DRAIN
- EWM --- EXISTING WATER MAIN
- EGM --- EXISTING GAS MAIN
- EOE --- EXISTING OVERHEAD ELECTRICAL
- (S) --- EXISTING SANITARY SEWER MANHOLE
- (SM) --- EXISTING STORM MANHOLE
- (S) --- EXISTING STORM DOUBLE WING INLET
- (S) --- EXISTING STORM SINGLE WING INLET
- (S) --- EXISTING STORM JUNCTION BOX
- (S) --- EXISTING WATER VALVE
- (S) --- EXISTING FIRE HYDRANT
- (S) --- EXISTING POWER POLE
- (S) --- EXISTING GUY ANCHOR
- (S) --- EXISTING LIGHT POLE
- (S) --- EXISTING MAILBOX

**DESIGN LEGEND**

- PSD --- PROPOSED STORM DRAIN
- (S) --- PROPOSED STORM DOUBLE WING INLET
- (S) --- PROPOSED STORM SINGLE WING INLET
- (S) --- PROPOSED ASPHALT/CURB REPLACEMENT
- SF --- PROPOSED SILT FENCE TYPE 'A'
- (S) --- PROPOSED RIPRAP

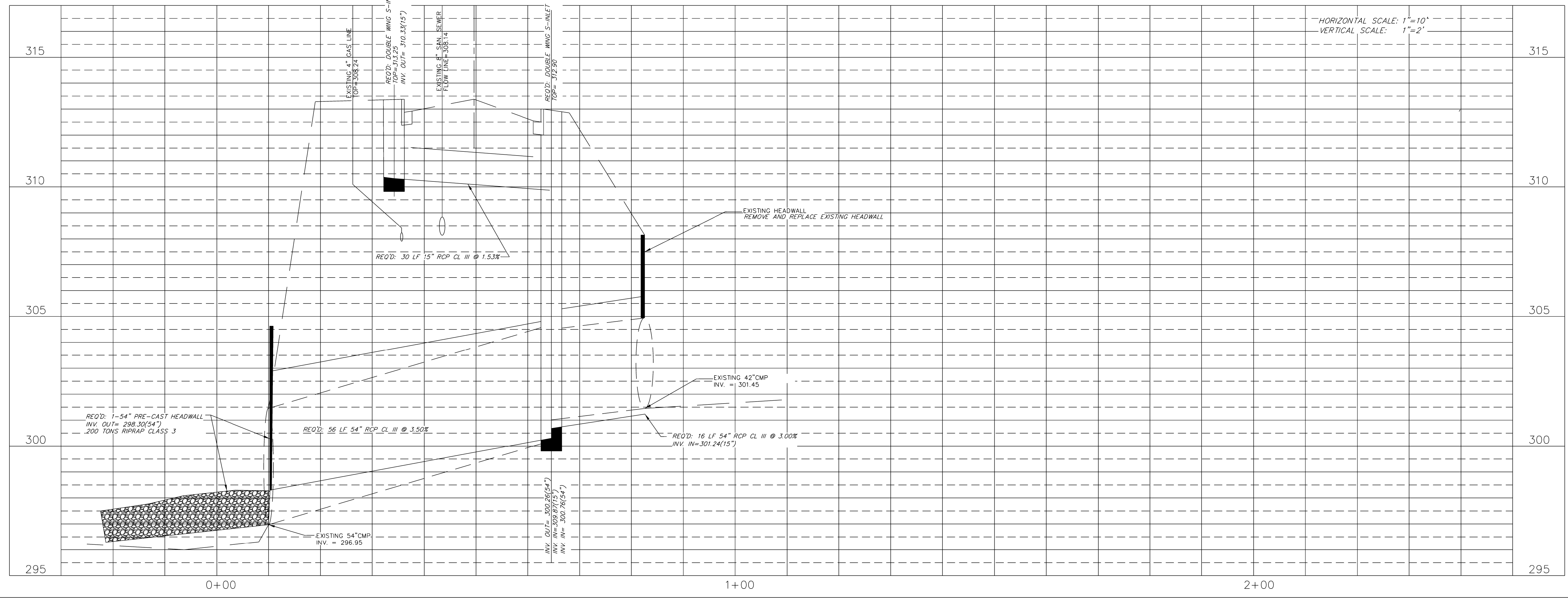
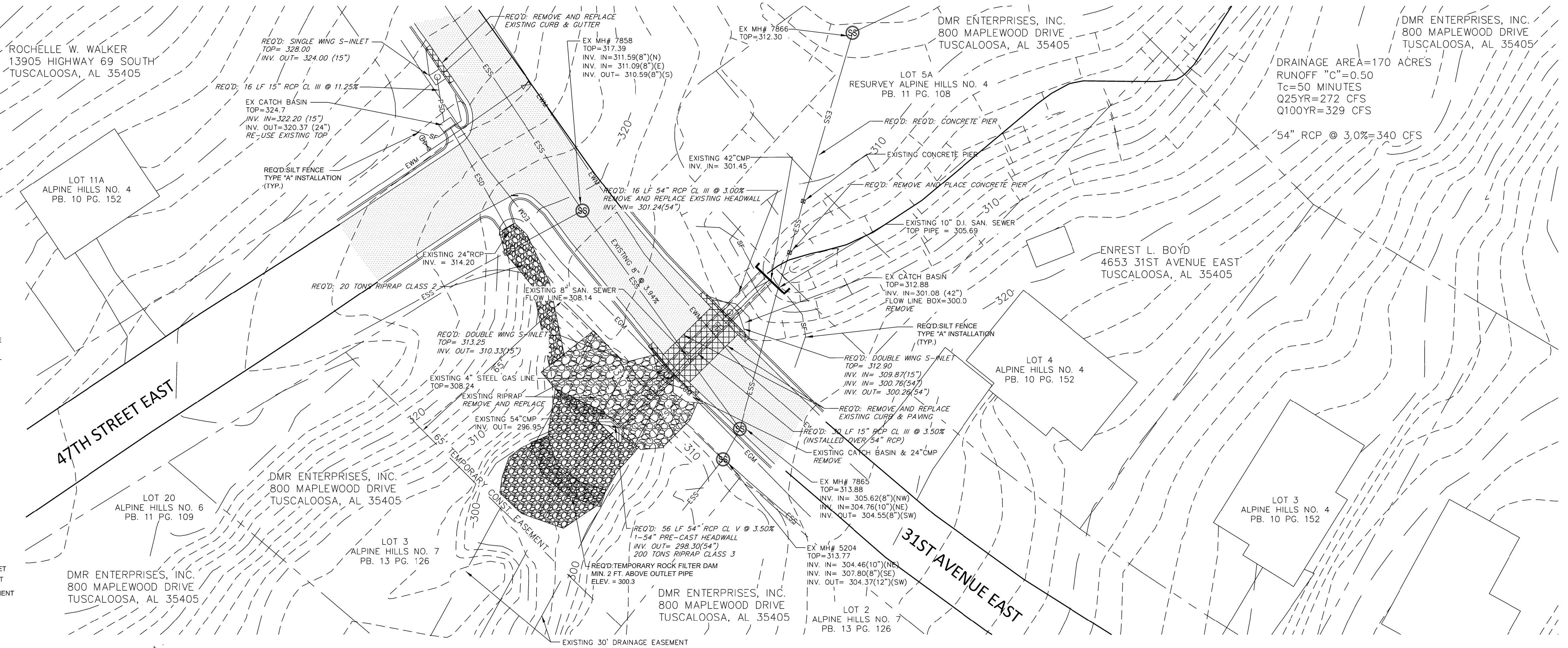

HORIZONTAL SCALE: 1"=10'  
VERTICAL SCALE: 1"=2'



OFFICE OF THE CITY ENGINEER  
2201 UNIVERSITY BLVD  
TUSCALOOSA, AL 35401  
PHONE: (205) 248-5380

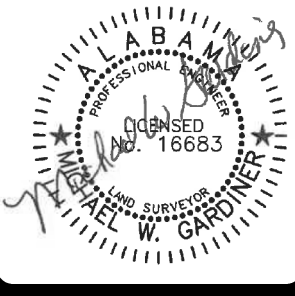

31ST AVENUE EAST  
CROSS DRAIN REPAIR  
PLAN & PROFILE

NO.	DATE	DESCRIPTION

SHEET NUMBER  
**C2.0**

DRAWN BY: MWC  
DATE: 6-25-20  
CHECKED BY: BMG  
PROJ. NO.: 2020.038.001  
FILE NAME: 31ST AVE PPI.DWG



REQD 2- TYPE III BARRICADES WITH R11-4 "ROAD CLOSED TO THRU TRAFFIC"  
 NOTE: PER MUTCD 6H-8, TYPICAL APPLICATION 6H-8, PLACE THE TYPE III BARRICADES AT THE EDGE OF THE TRAVEL WAY TO ALLOW LOCAL TRAFFIC TO PASS.

WARNING LIGHT TYPE B W/DETACHABLE HEAD

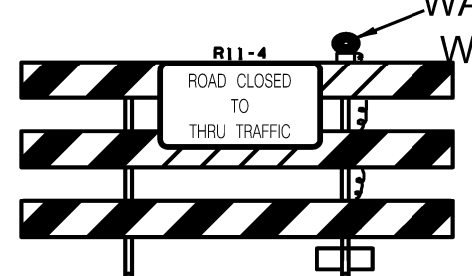

REQD TYPE III BARRICADE WITH R11-2 "ROAD CLOSED"  
 WARNING LIGHT TYPE B W/DETACHABLE HEAD



W20-1 ROAD CLOSED AHEAD

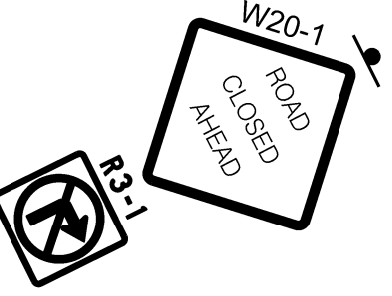

W20-1 ROAD CLOSED AHEAD



R3-2



REQD 2- TYPE III BARRICADES WITH R11-4 "ROAD CLOSED TO THRU TRAFFIC"  
 NOTE: PER MUTCD 6H-8, TYPICAL APPLICATION 6H-8, PLACE THE TYPE III BARRICADES AT THE EDGE OF THE TRAVEL WAY TO ALLOW LOCAL TRAFFIC TO PASS.

WARNING LIGHT TYPE B W/DETACHABLE HEAD

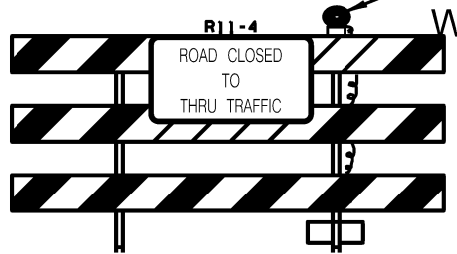

**31ST AVENUE EAST  
 CROSS DRAIN REPAIR  
 TEMPORARY TRAFFIC CONTROL PLAN**

NO.	DATE	DESCRIPTION

DRAWN BY: MWG  
 CHECKED BY: MWG  
 DATE: 7/16/2020  
 PROJECT NO.: 2020.038

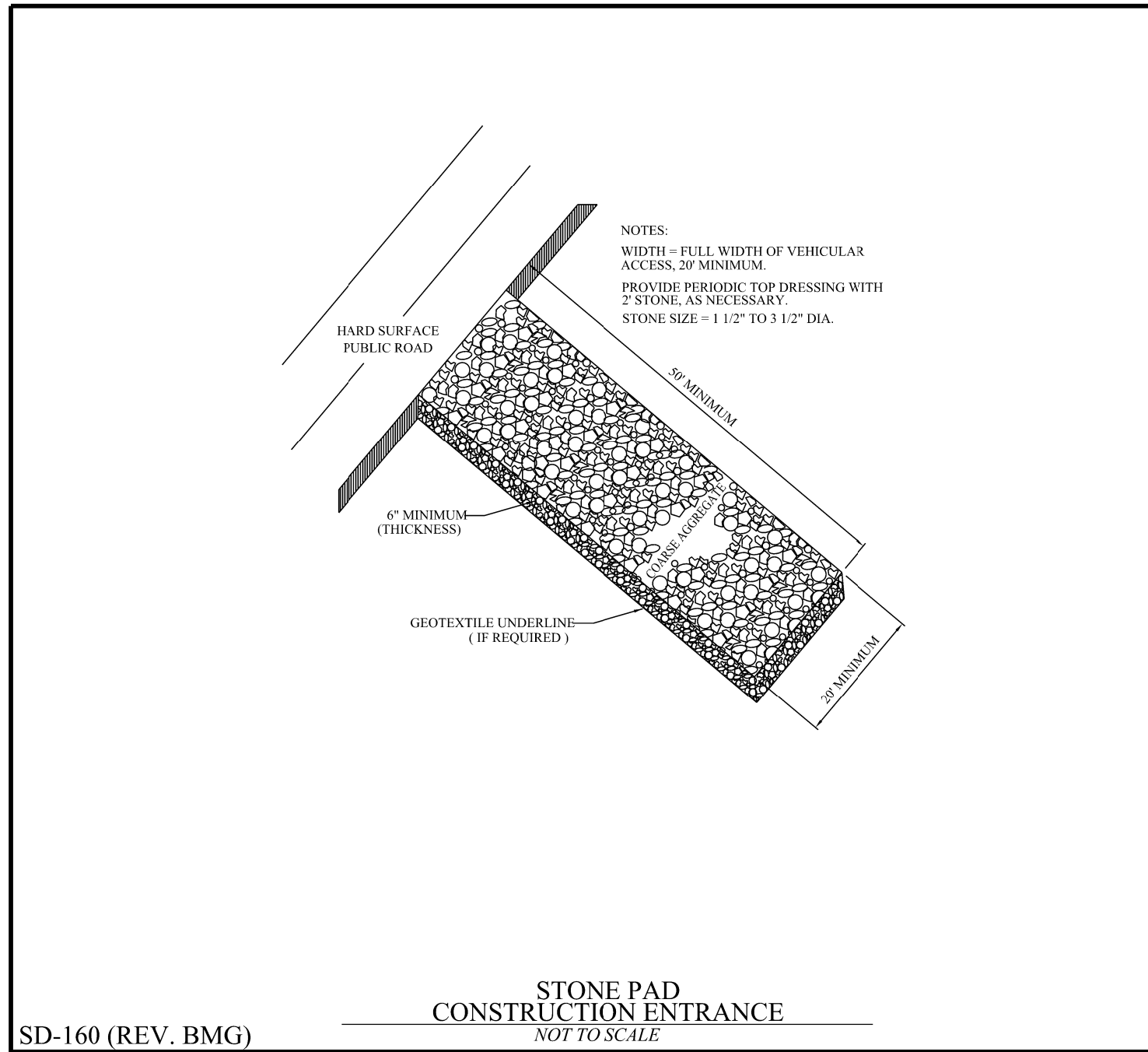

SD-160 (REV. BMG)

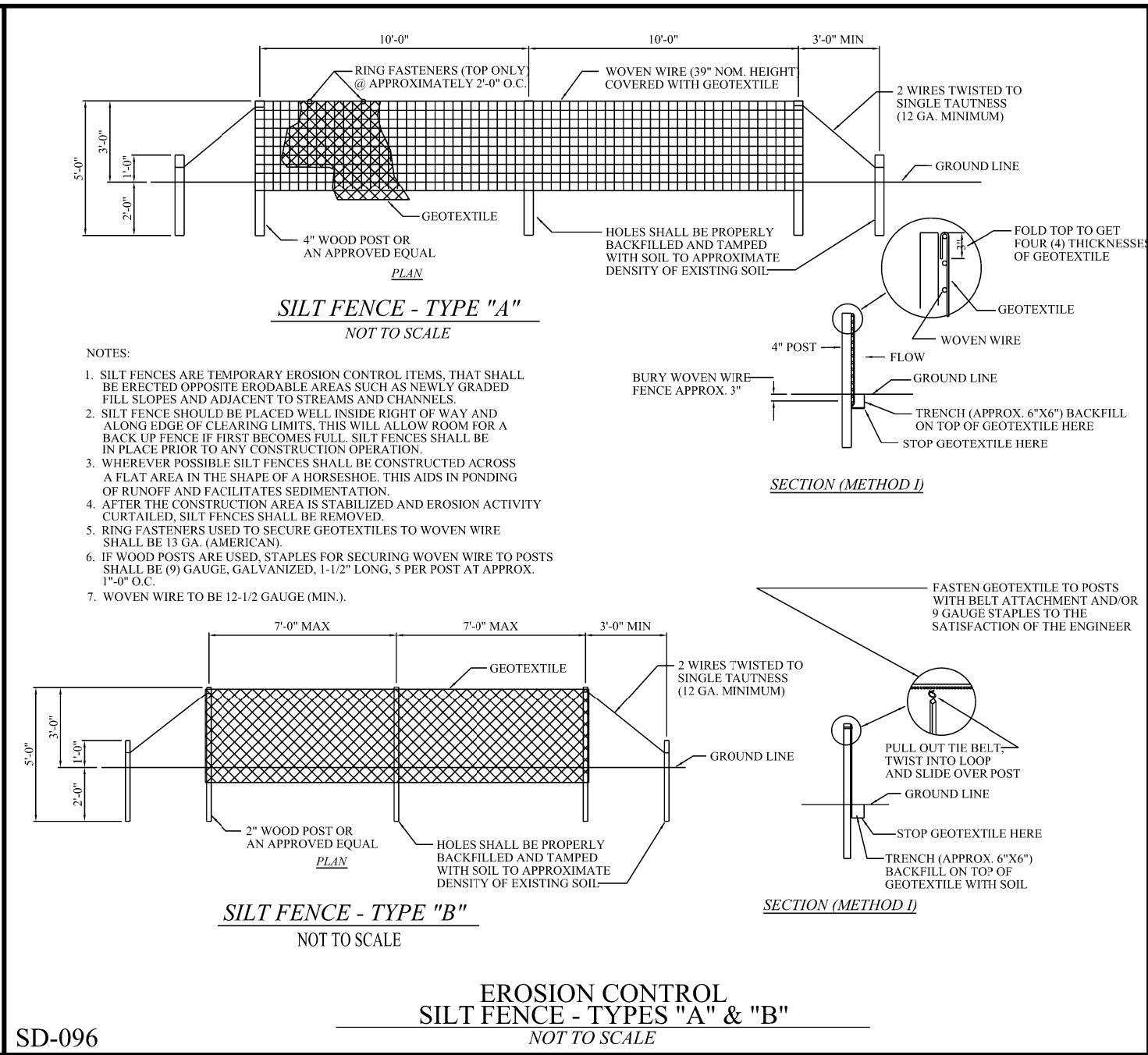

SD-096

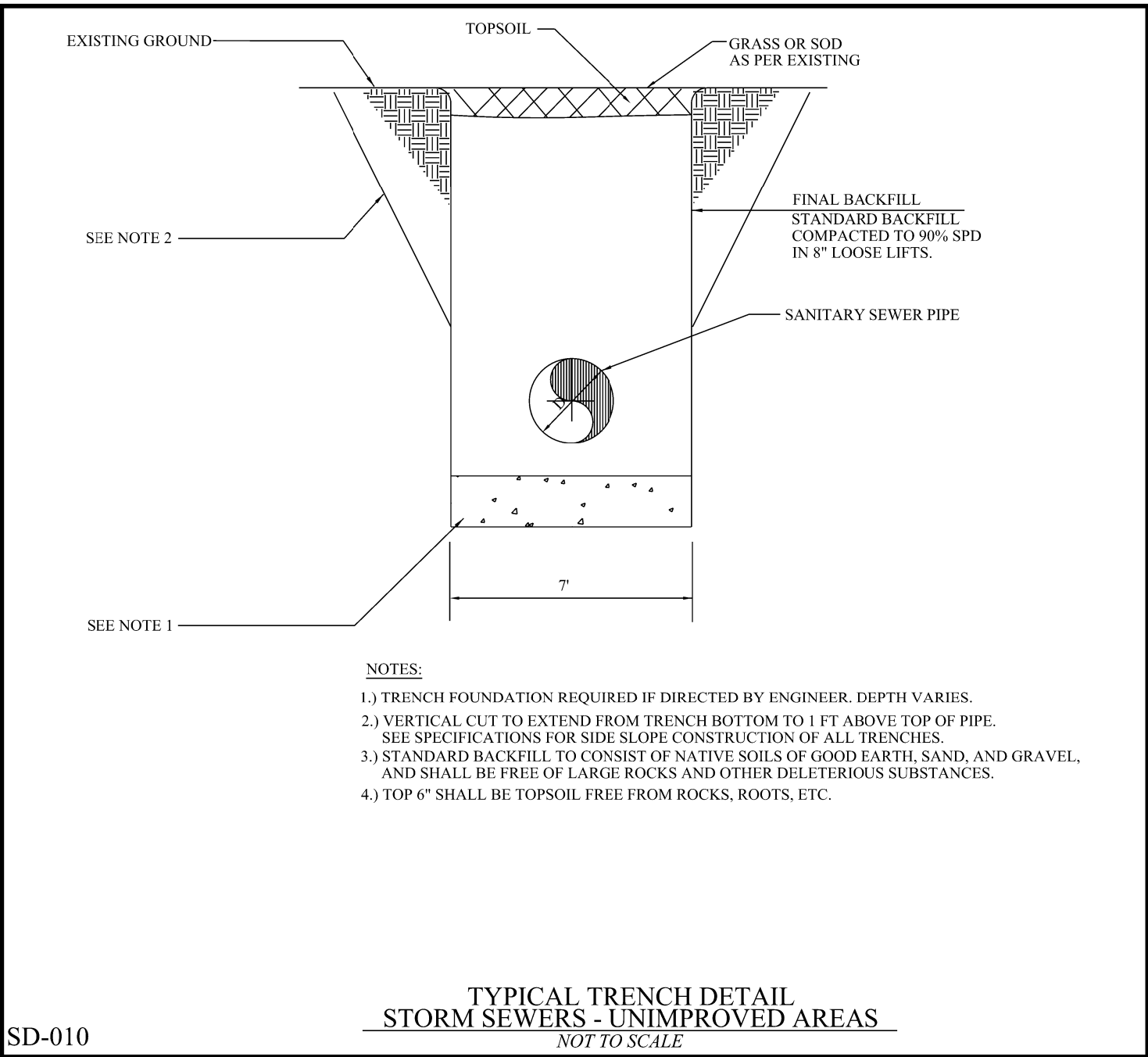

SD-010

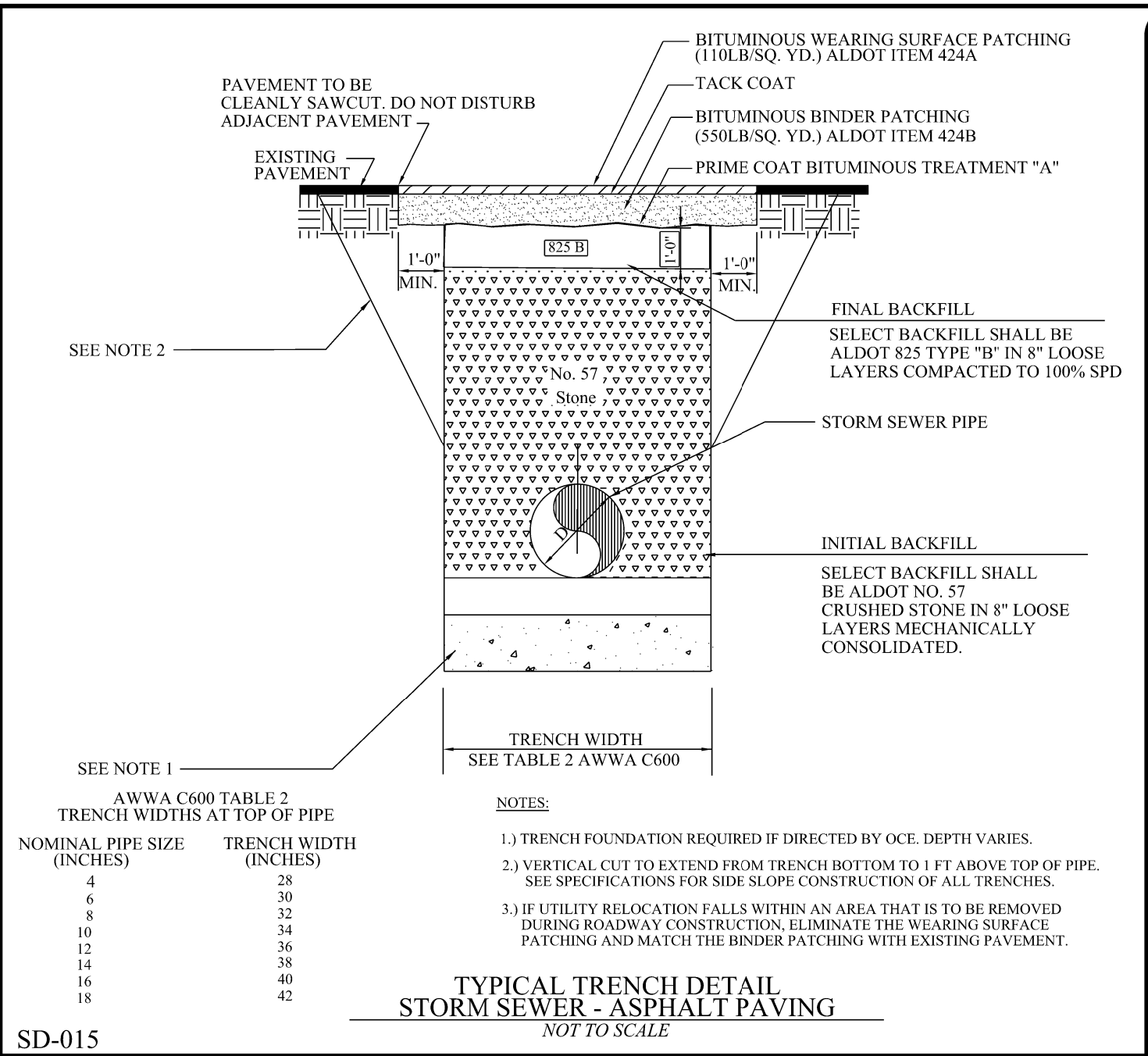

SD-015

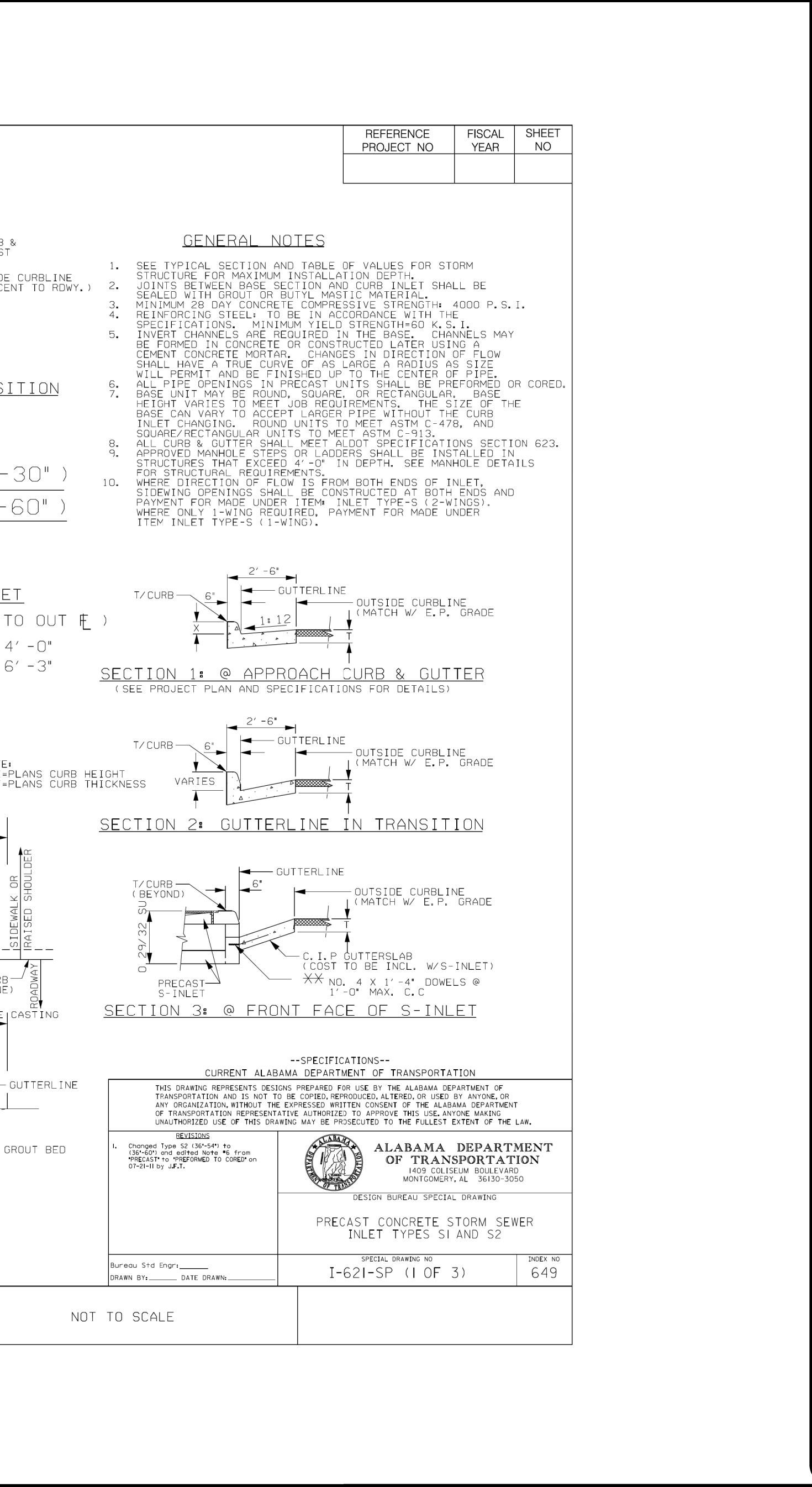
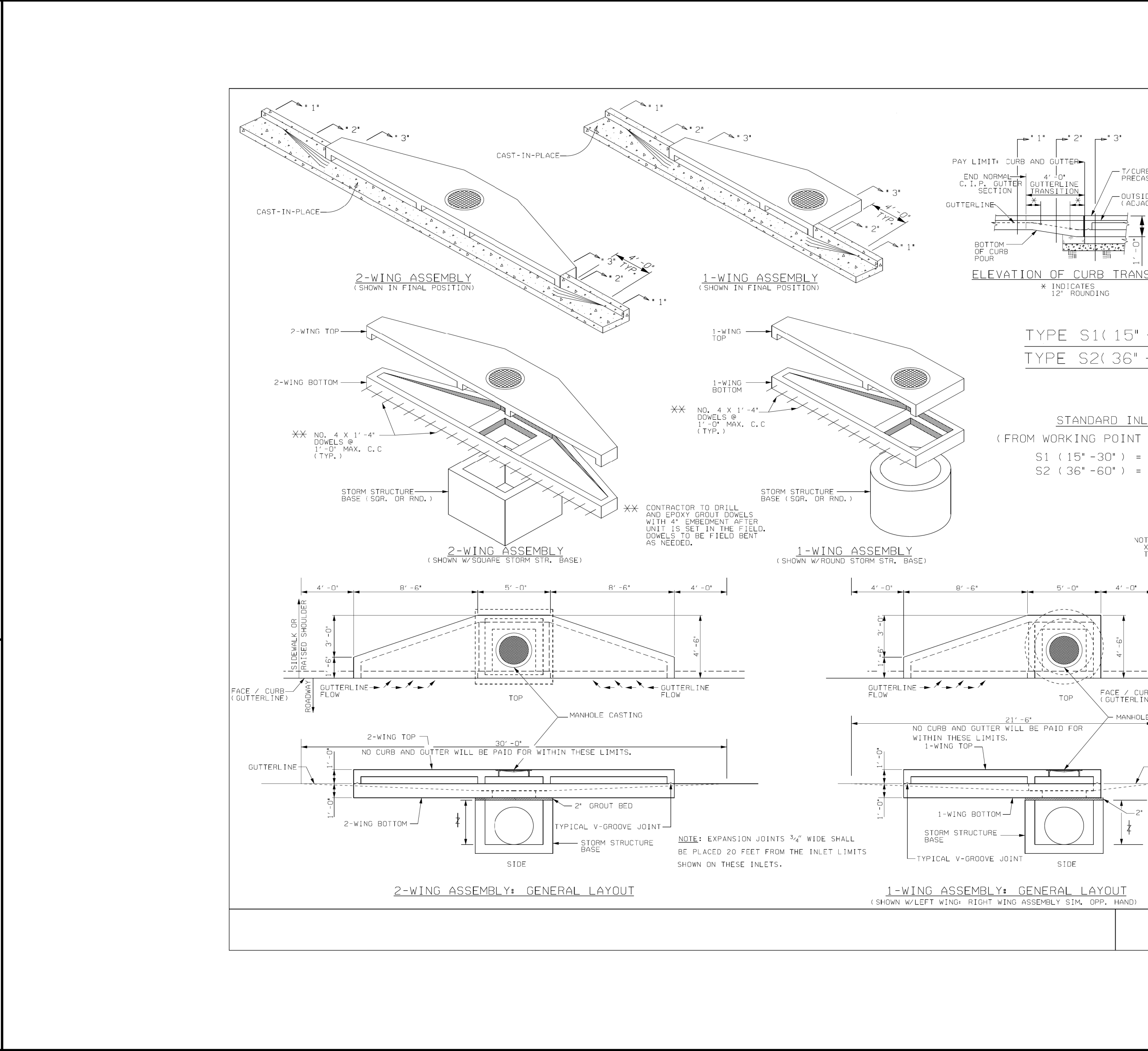
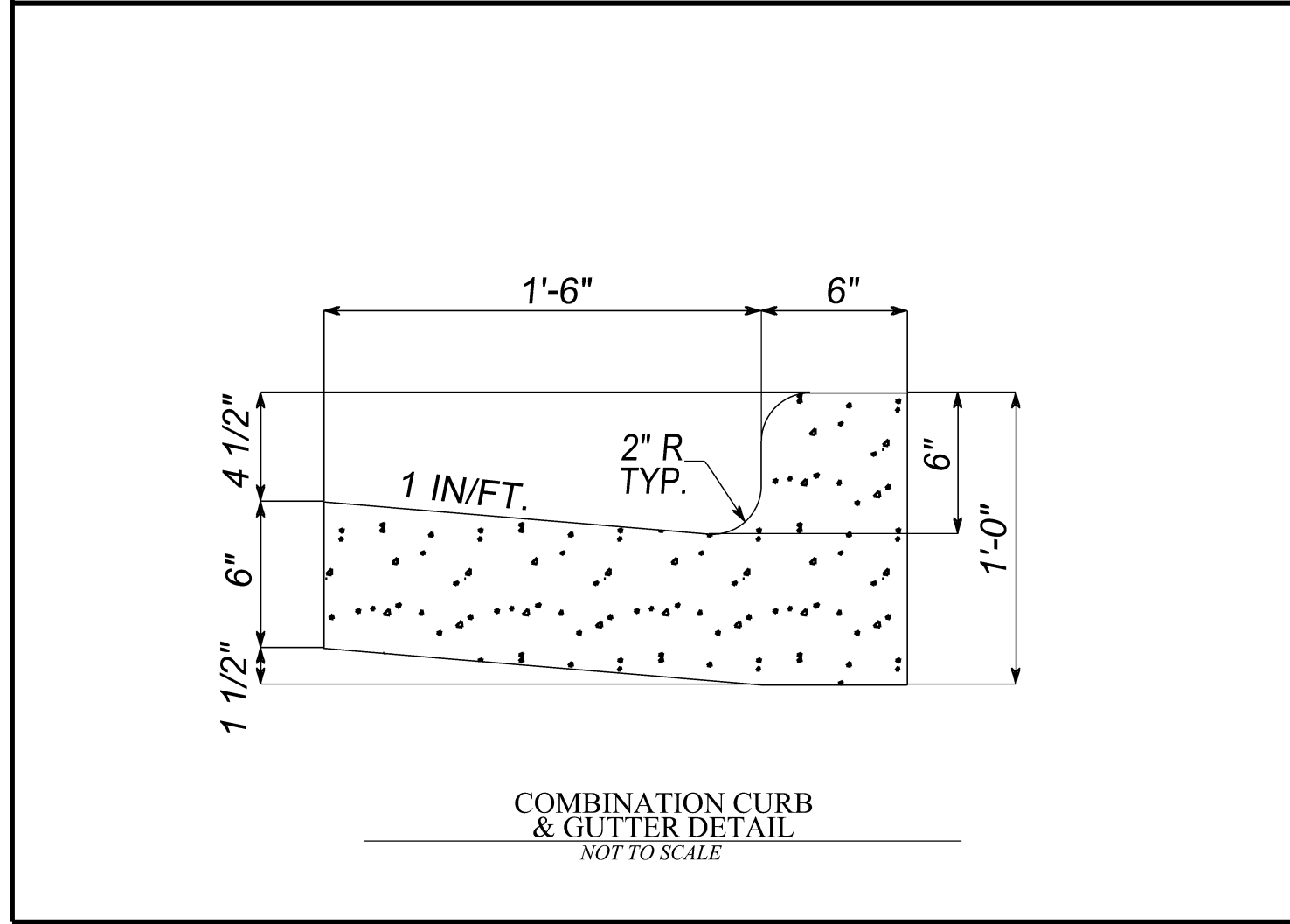
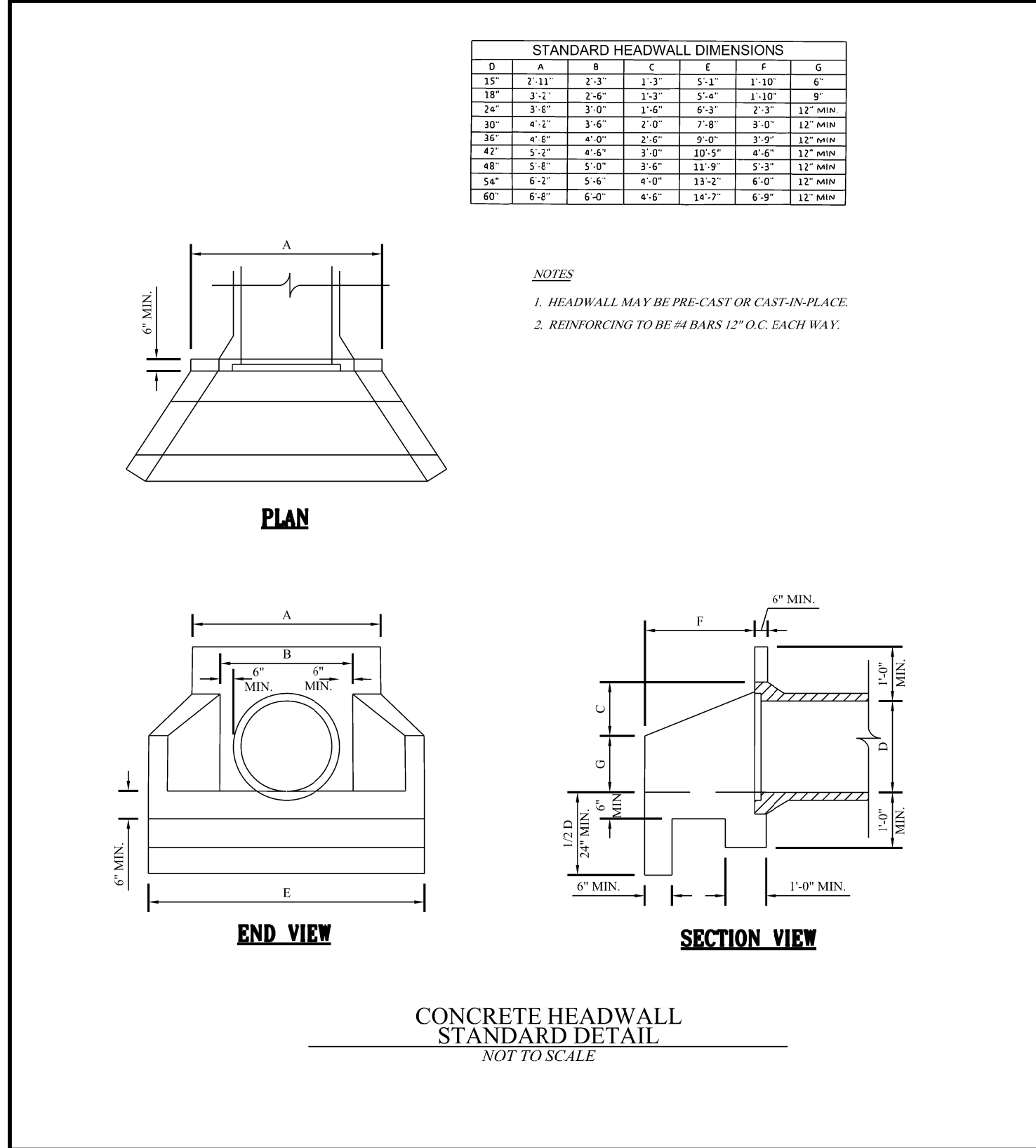

**OFFICE OF THE CITY ENGINEER**  
2201 UNIVERSITY BLVD  
TUSCALOOSA, AL 35401  
PHONE: (205) 248-5380

**TUSCALOOSA ENGINEERING**

**31ST AVENUE EAST CROSS DRAIN REPAIR**

**STANDARD DETAILS**

NO. DATE DESCRIPTION

DRAWN BY: CRC  
CHECKED BY: MWG  
DATE: 7/17/2020  
PROJECT NO.: 2020.038

SHEET NUMBER  
**C4.0**

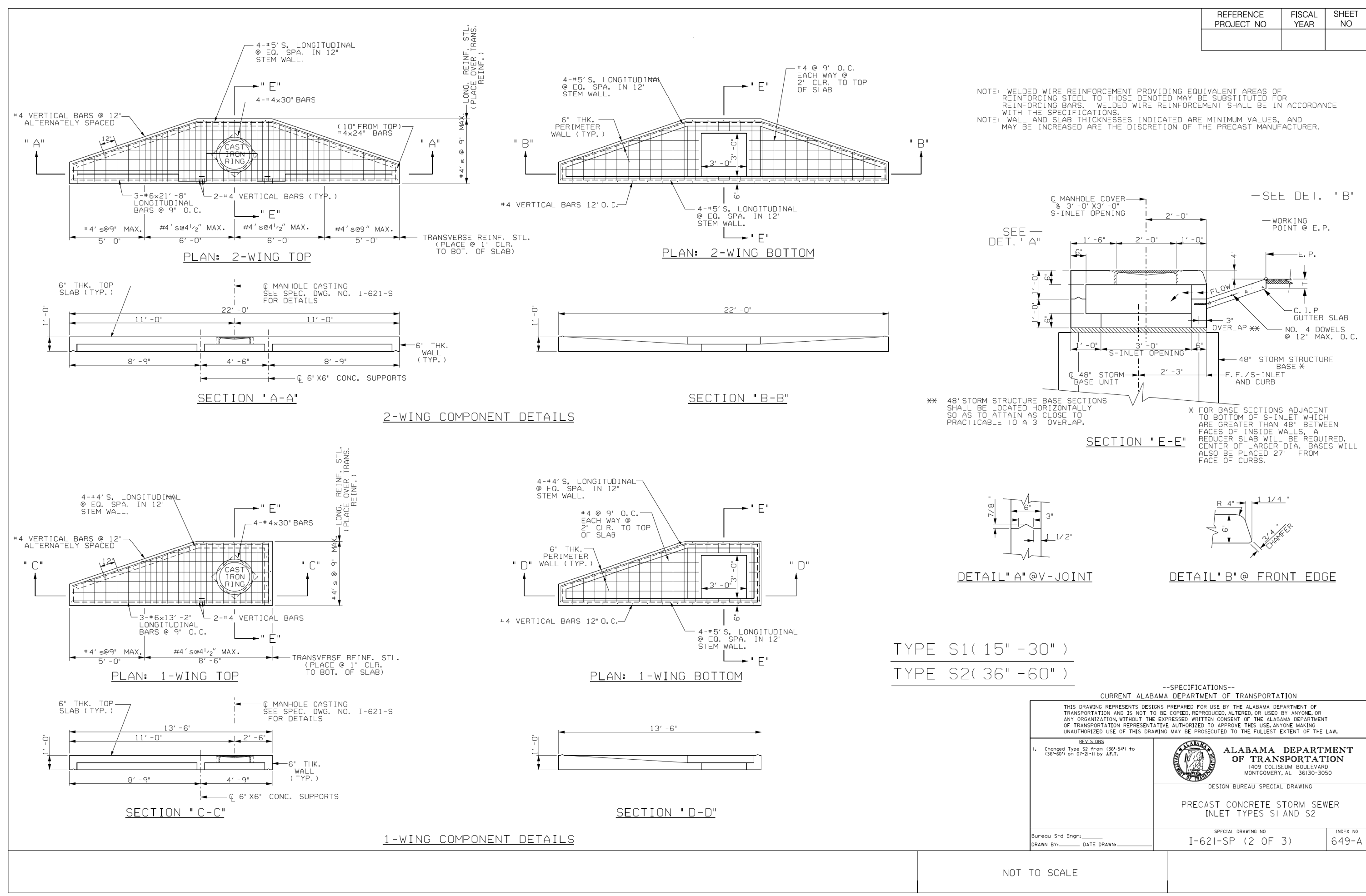

**NOTES:**  
 1. ALL CONCRETE SHALL BE PROPORTIONED TO PROVIDE A MINIMUM OF 4000 PSI COMPRESSIVE STRENGTH AT 28 DAYS.  
 2. REINFORCING STEEL USED IN CONCRETE SHALL CONFORM TO ASTM A 615 INCLUDING S1 GRADE 60.

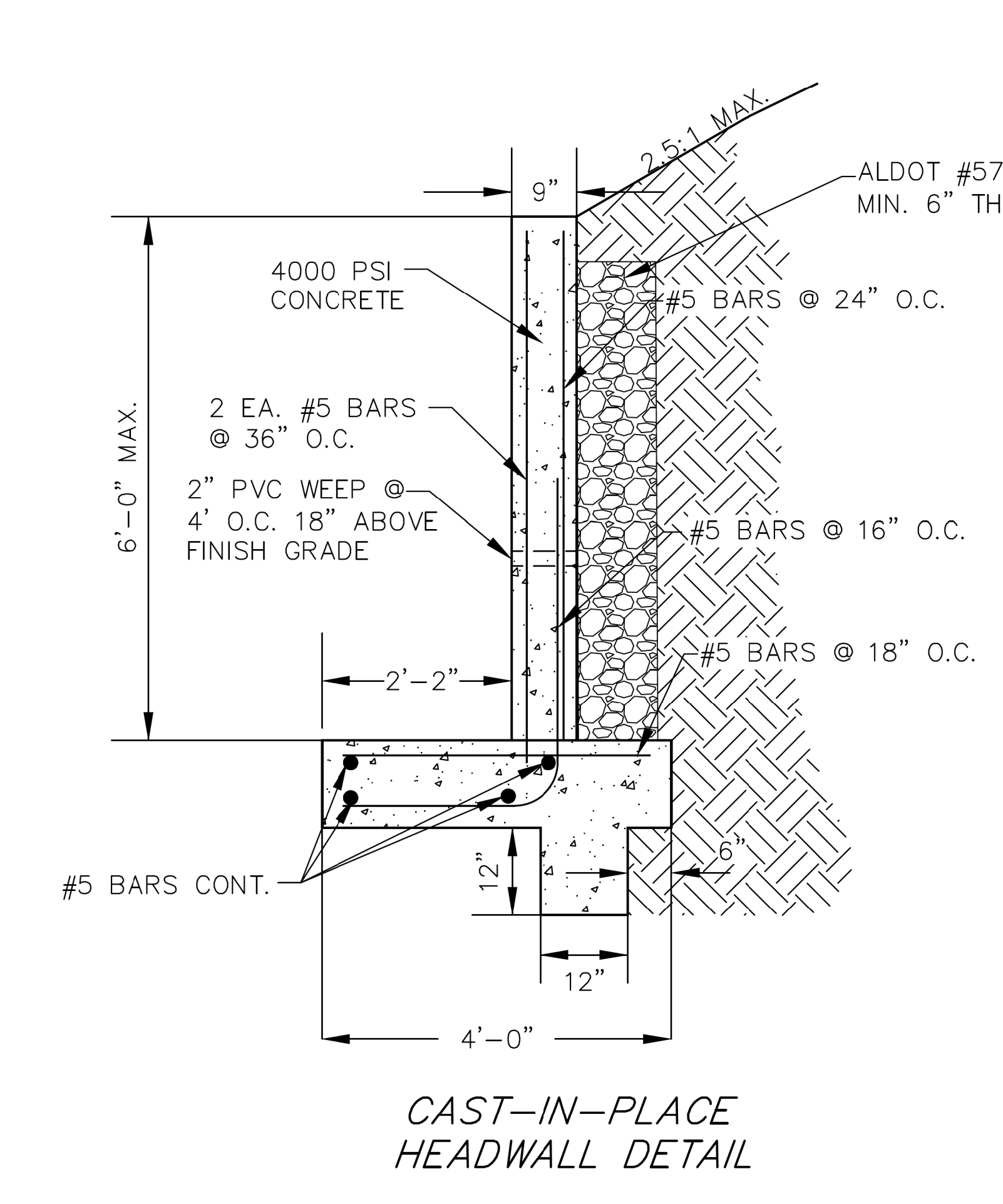
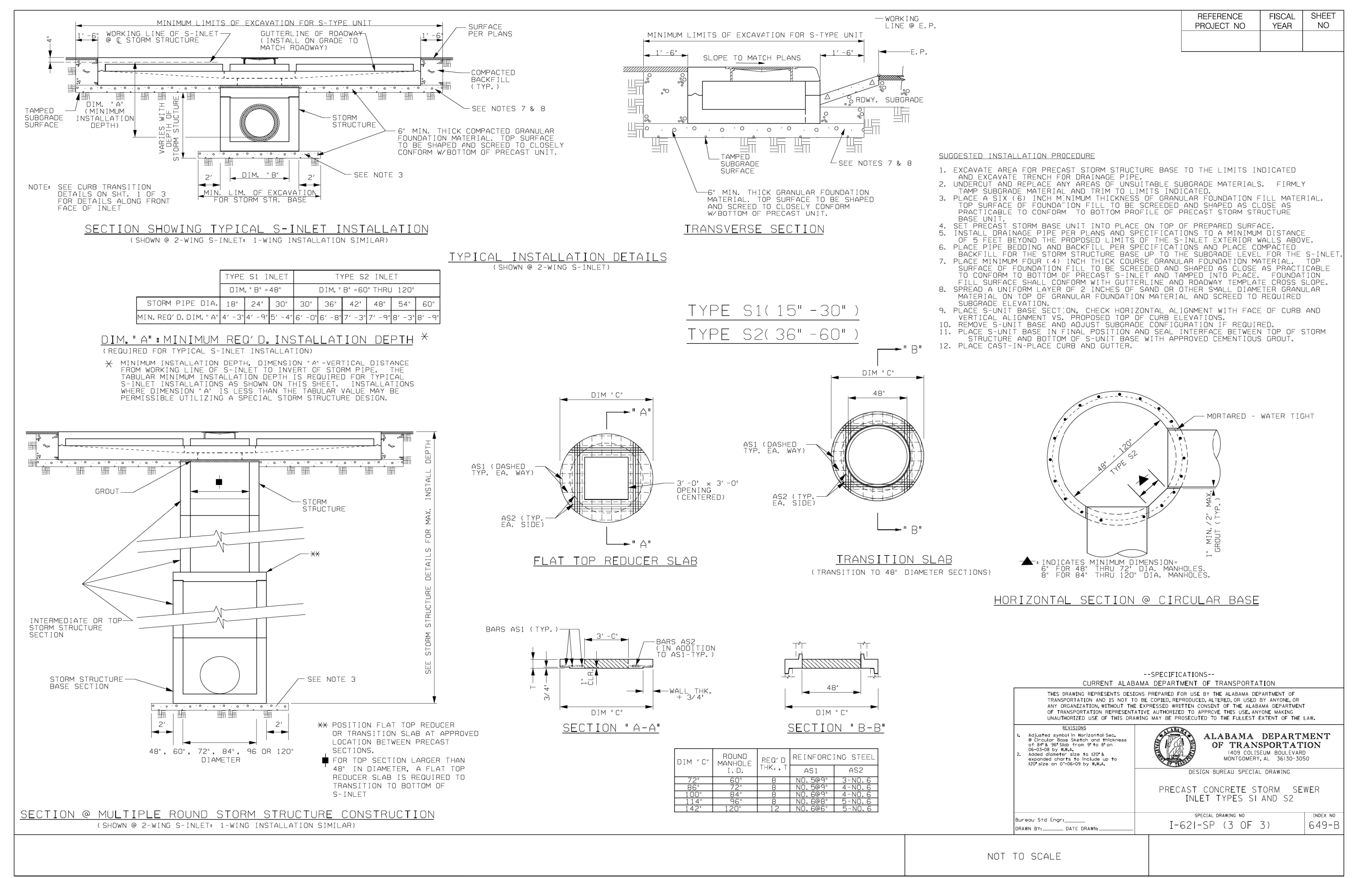
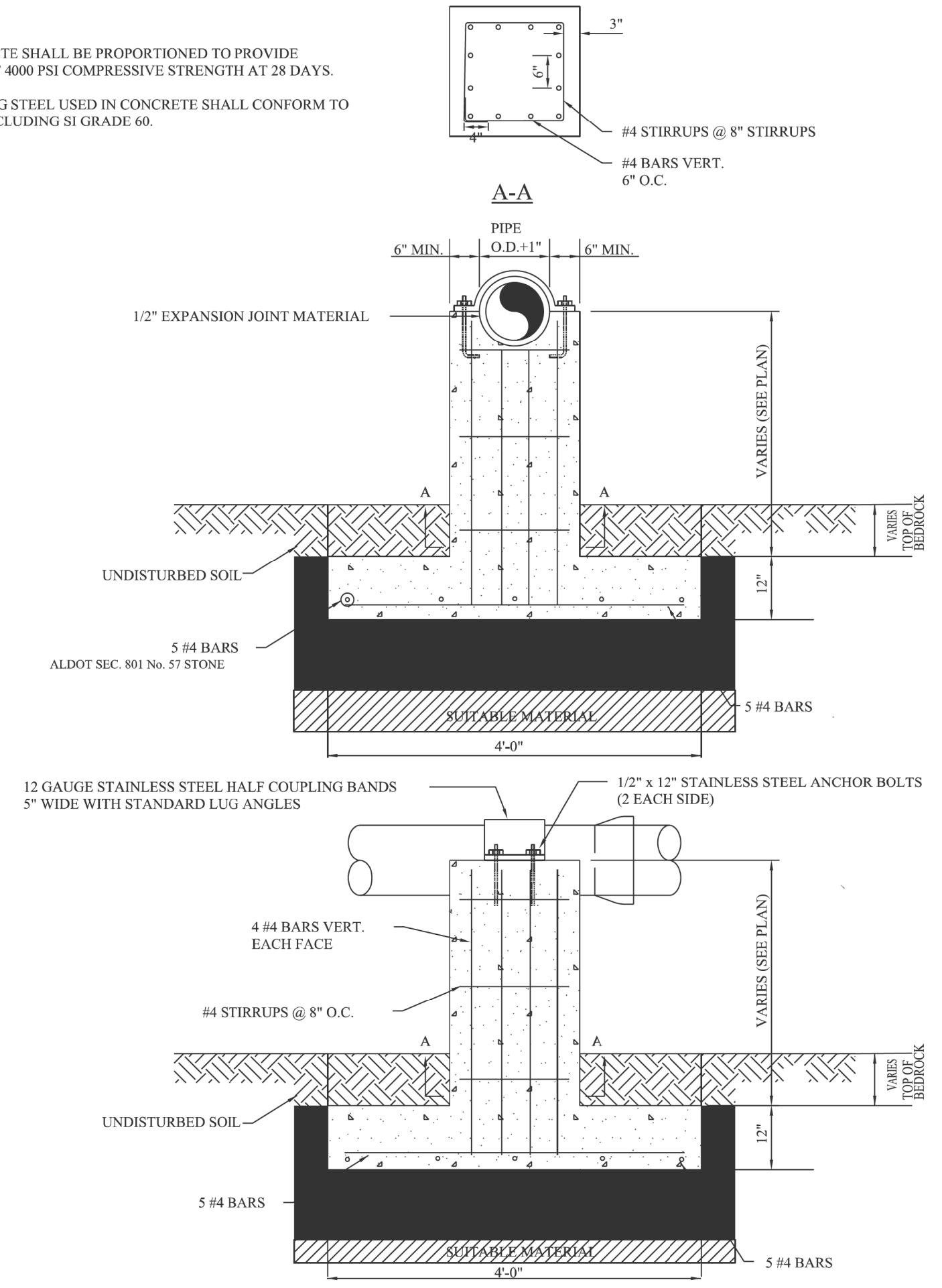

**OFFICE OF THE CITY ENGINEER**  
 2201 UNIVERSITY BLVD  
 TUSCALOOSA, AL 35401  
 PHONE: (205) 248-5380

**TUSCALOOSA ENGINEERING**

**31ST AVENUE EAST CROSS DRAIN REPAIR**

**STANDARD DETAILS**

**NO.**    **DATE**    **DESCRIPTION**

**DRAWN BY: CRC**    **CHECKED BY: MWG**

**DATE: 7/17/2020**    **PROJECT NO.: 2020.038**

**SHEET NUMBER C4.1**